

INSTRUCTION MANUAL

ELOFLEX R

BRUKSANVISNING

BRUGSANVISNING

OHJEKIRJA

MANUALE DI ISTRUZIONI

HANDLEIDING VOOR GEBRUIK

GEBRAUCHSANWEISUNG

INSTRUKCJA OBSŁUGI

HASZNÁLATI UTASÍTÁS

MANUEL DE L'UTILISATEUR



ELOFLEX

Welcome to your Eloflex

Thank you for choosing Eloflex as your power wheelchair. We are delighted that you have opted for Eloflex, as our mission is to simplify everyday life and enhance freedom for people with mobility challenges. We hope your Eloflex allows you to enjoy both benefits.

Using your new power wheelchair should be a rewarding experience. This manual contains crucial information on safety, usage, and maintenance. We strongly recommend reading through the entire document before using your Eloflex for the first time. It is also advisable to practise operating your Eloflex in a quiet, open, and level space before venturing into other environments.

We are here to support you as you start using your Eloflex. If you have any questions or need assistance, please feel free to contact us.

**Good luck and great joy with your Eloflex.
Drive carefully!**

Content

Intended use	3
Unfolding and Folding	4
Anti-tip device	4
Charging Instructions	5
Install the joystick	5
Using the joystick	6
Additional functions	7
Manual Driving	7
Footrest	8
Backrest	8
Lift the armrests	9
Transport and storage	9
Driving	10
Safety	11
Technical specifications	12
Contact	12

Sida

3
4
4
5
5
6
7
7
8
8
9
9
10
11
12
12



Intended use

Type classification and intended use

Eloflex power wheelchairs have been developed for people who have difficulty walking or cannot walk at all, but who have the vision, physical, and mental ability to control a power wheelchair.

The Eloflex power wheelchair is sufficiently compact and flexible for indoor use, but it is also suitable for outdoor use. The chapter "Technical Data" at the back of this document contains information on speed, turning radius, range, maximum lifting capacity, maximum user weight, etc.

Eloflex is tested and approved according to EN12184:2014 - Class B (indoor and outdoor use). Eloflex is also approved according to ISO-7176, IEC60601, and the batteries are approved according to UN38.3.

Eloflex power wheelchairs meet the applicable requirements of MDR 2017/745.

MDR Class 1 conformity assessment/CE marking has been issued in accordance with Article 19 and Annex II and III of MDR 2017/745. The CE marking will be void if you use replacement components or accessories that have not been approved for this product.

Needs

The purpose of an Eloflex power wheelchair is to compensate for an injury or disability, and it is recommended in the following circumstances:

- If the user is unable to walk or has very limited ability to walk, making it difficult to move within their own home.
- If there is a need to leave the home to go out or visit places regularly attended for everyday affairs.
- When the user has difficulty reaching or performing work or activities due to mobility disabilities.

It is advisable to use Eloflex power wheelchairs both indoors and outdoors if it is not possible to use hand-operated wheelchairs due to mobility problems, but it is still possible to properly handle power wheelchairs.

Accessories

The charger, reflectors, and a bag with simple tools are provided in the storage bag under the seat upon delivery.

Utility

Only use the Eloflex power wheelchair when it is fully functional; otherwise, you put yourself and others at risk. The following list does not include all possible situations but describes certain conditions that may affect the usability of the power wheelchair:

- Do not use the power wheelchair if the batteries are defective or deformed.
- Do not use the power wheelchair if the engine is jerky or makes abnormal noises.
- Do not use the power wheelchair if the brake function appears to be faulty.
- If your tyres are worn, contact your assistance centre or dealer.
- If you notice any damage to the seat belt, armrest, seat, backrest, joystick, or other parts of the chair, contact your assistance centre or dealer.
- If you notice any damage to the electrical system (cables, batteries, chargers, etc.), please contact your assistance centre or dealer.

Manufacturer's warranty

The Eloflex warranty covers the replacement of parts that are broken, provided the damage is not caused by the user. The warranty does not cover damage resulting from external circumstances such as theft, abuse, misuse, lightning, or modification.

Life span

The estimated lifetime of an Eloflex is 5 years. However, the lifespan of the product is greatly influenced by how it is used and maintained. An Eloflex can last much longer if it is well cared for and used in accordance with the information provided in this document.

Safety regulations and risks

THE USER MUST READ THE SAFETY AND DRIVING INSTRUCTIONS IN THIS DOCUMENT BEFORE USING ELOFLEX WHEELCHAIRS.

Unfolding and Folding

Unfolding

Step 1

Place the folded chair on the ground as shown on the right. Unlatch the transport lock found on the backside of the backrest. Hold the backrest and pull it upwards to open the chair. With your other hand, push the seat downwards until you hear a clear "click," which indicates the lock is engaged.



Step 2

Important! Ensure the locking latch is fully closed to secure the chair in its unfolded position.



Check the lock before use

Fold

Step 1

Push the red button to release the main locking latch as shown in the picture.



Step 2

Place one hand on the front of the seat cushion. With the other hand, grasp the top of the backrest and fold it forward. Push the chair together as shown in the picture.

Pinch points! Be careful when folding.



Step 3

A practical transport lock can be engaged to help keep the wheelchair in a folded position. Rotate the transport lock until it secures the opposite rod.

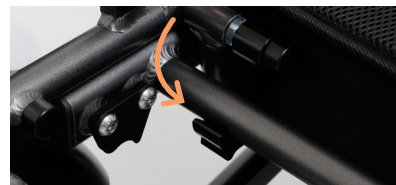

Anti-tip device

Slide the red button and fold the anti-tip upward to retract it. The anti-tip device does not need adjustment but can be retracted for transport on some models. The wheelchair must not be used without the anti-tip device active, as this poses a risk of serious injury. Check it before each use.



RISK OF INJURY!
Always ensure the anti-tip devices are active.

Charging Instructions

Before You Begin

- Charge your Eloflex upon delivery.
- Only use the original charger supplied with your Eloflex.
- The charger is designed to connect to the joystick only, not directly to the batteries.
- Charge at least every 3 months to prevent permanent battery damage.

How to Charge

Aim to charge your Eloflex after each ride or when the battery indicator on the joystick drops three lines. Start by turning off your Eloflex (all lights on the joystick should be off).

Connect the charger to the socket on the front of the joystick. Ensure the contacts match up.

Plug the charger's power cable into a wall outlet. Charging is indicated by a lamp on the charger. A red light means charging is in progress. After about three hours, the batteries are 90 percent charged, and the chair can be used.

After about 5-8 hours, the charger light will turn green, indicating the batteries are fully charged. During charging, the charger will become warm, which is normal.

Always disconnect the charger from both the wall outlet and the wheelchair when charging is completed. Never charge unattended. The batteries can be charged down to 0 degrees. When charging at lower temperatures, the batteries may not fully charge.

If your Eloflex is used in sub-zero temperatures, the range is affected. For example, at -10 degrees, the range can be reduced by up to 50%.



Long-term Storage

The batteries may be permanently damaged if the voltage drops too low. We recommend disconnecting the batteries to minimise discharge and recharging them regularly (at least once every 3 months). Never leave the charger permanently connected.



Not charging the batteries regularly will cause permanent damage

Install the joystick

Step 1

Mount the joystick by assembly the quick lock onto the armrest with the latch facing outwards. Adjust the nut so that the latch can be fully closed yet securely holds the joystick in place. The joystick can be mounted on right or lefthand side.



Step 2

Connect the cable connectors together and carefully twist them until the pins fit into the holes and the grooves in both connectors match up. Then, securely screw the sleeves onto each connection point.



Please take care to avoid damaging or bending the pins in the connector.

Using the joystick



- 1 Speedometer:** Displays your current speed.
- 2 Speed setting:** Shows the distance you've travelled and your current speed.
- 3 Trip/ODO meter:** This displays the distance driven since the last power-on (trip) or the total distance for the vehicle (ODO).
- 4 Battery level:** Indicates the remaining power in the batteries. When fully charged, all bars are white. It's recommended to recharge when three bars have been used.

USB connector

TIP: Use the USB connector underneath the joystick to charge your mobile phone.



Charger input

Light



Joystick: Controls the chair's speed and direction.

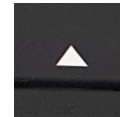

Increase speed: Press to make the chair go faster.

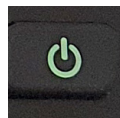

Power on and off: Press to switch your Eloflex on or off.

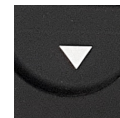

Reduce speed: Press to make the chair go slower.



Horn: Press to sound an alert for attention.



On/off light: Press to turn the light on or off.

Additional functions

Adjusting Settings

You can modify the chair's settings, including language, horn volume, and measurement units.

1. To access the settings, press the right multifunction button. This will display a list of options.



2. Use the speed buttons to scroll up and down through the list of options

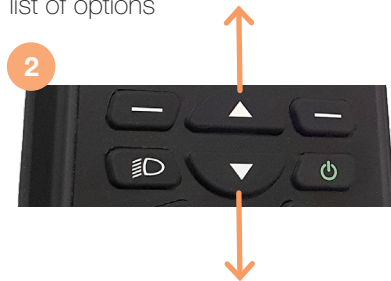

3. Select a function by pressing the right multifunction button (Enter), or go back one step by pressing the left multifunction button (Return).

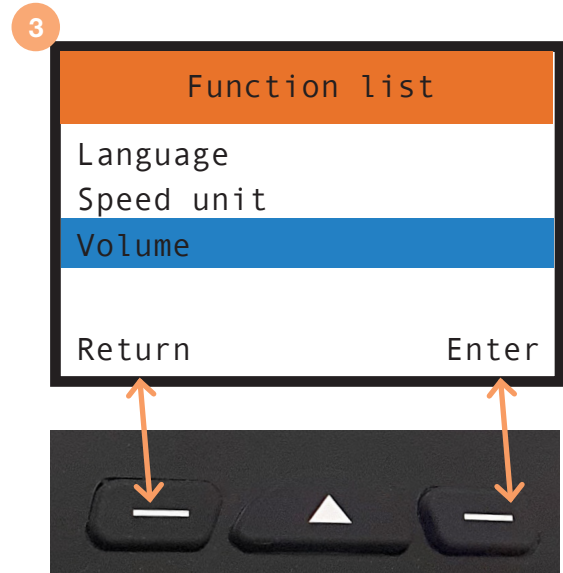

Lock / Child Safety

You can electronically lock your Eloflex by pressing the up and down arrows simultaneously for 3 seconds. A small symbol at the top of the display will indicate that the lock is activated. (The joystick must be powered on to lock/unlock.)

USB Charging Port

The USB port can charge mobile phones, iPads, and other portable devices. It supplies 5V power with the charging current determined by the connected device, up to a maximum of 2.1A.

Warnings

The display is capable of showing fault codes to indicate errors. Fault codes 1 and 2 indicate that the magnetic brakes are active.

Remote Control via App

The Eloflex wheelchair can be controlled via an app. Use the QR codes below to download it. Contact your dealership for detailed instructions if needed. NOTE: App control should not be used as an assistant control device (e.g., when a person is sitting in the chair).



Manual Driving

Turn off the power wheelchair using the joystick. Then, push the red levers on the motors (see picture) to disconnect the magnetic brakes. In this position, the chair can be rolled manually.

Note:

If the user operates the chair without assistance, the magnetic lock must always be engaged.



Do not push the red levers with your foot; use only your hands.

Footrest

For easier entry and exit, the footrest can be folded up and in as shown below.

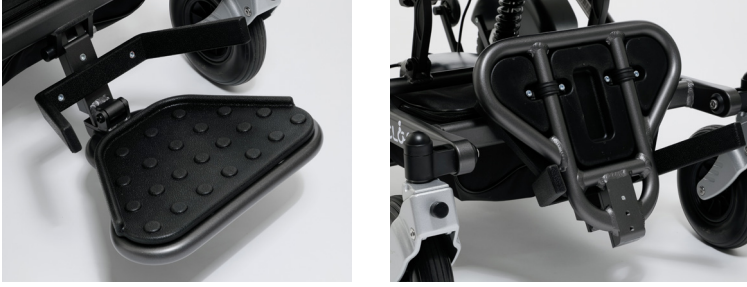

Adjust the footrest

The footrest can be adjusted vertically and horizontally in fixed positions. Loosen the bolt, move the footrest to the desired position, and gently tighten the bolt, ensuring it aligns with the threaded hole. Tighten the bolt.

If the footrest does not remain in the raised position, you can adjust the inertia of the footrest by tightening the fixing screws.

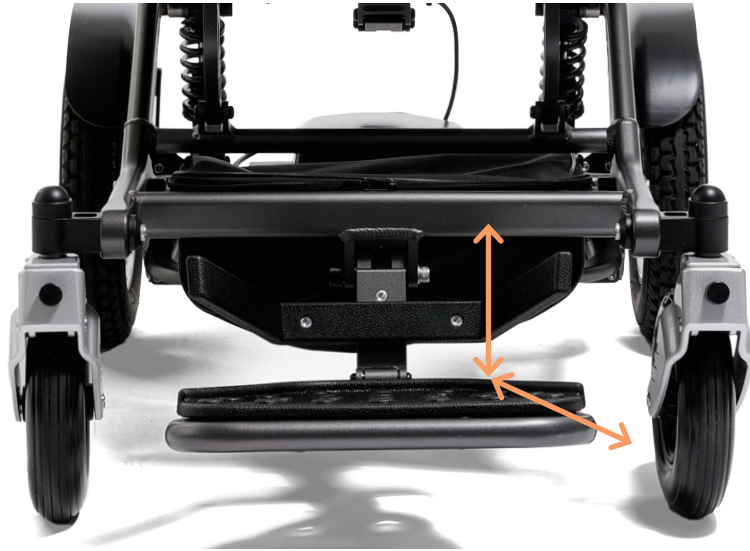

Backrest

Adjust the backrest

Adjust the inclination of the back by pushing down the levers on the sides and position the backrest in an angled position that feels comfortable. Then release the levers to lock the position.

You can choose between 8-30 degree angle.



Lift the armrests

To lift the armrests up, first loosen the lock by turning the locking lever half a turn. Then lift the armrests. Please make sure to lock the armrest again when down due to risk of injury. Adjust the armrest horizontally (forwards/backwards) by pressing the small button under the armrest and sliding the pad. Release the button to lock it in place.

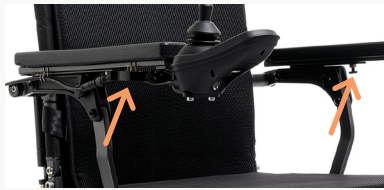

Transport and storage

- To lift the chair, it is recommended that it's first folded lying flat, then raised into an upright position before finally being lifted.
- A folded chair can be put in the luggage of a car or set in a wardrobe.
- Fold down or remove the joystick during transport.
- If the chair is not to be used for a while, make sure its stored correctly and the batteries periodically charged according the chapter "How to charge". Otherwise the chair might become unusable.
- The chair should be stored indoors in frost-free, dry and ventilated areas. Storage temperature 0-30 degrees.
- Cushion covers are removable and washable at 40°C.

- When transporting by bus or by handicap transportation, the Eloflex must be attached to the fastening points shown in the pictures at the bottom. **Note! Eloflex is not tested or approved as a car seat. Therefore its not allowed to be seated in the Eloflex during car transport.**
- When transporting by air, please confirm with your airway company prior to both booking and check-in. Eloflex follows the recommendation of IATA.



Driving

Read

The user must read these safety and driving instructions before using the Eloflex power wheelchair.

Practice

Practice makes perfect. Train to drive your Eloflex together with an assistant by starting on an open plan surface, preferably outdoors, before using your power wheelchair among other people, in stores or restaurants etc. Move forward by moving the joystick slowly forward. Stop by releasing the joystick.

Reverse

Reverse by moving the joystick slowly backwards. To stop, release the joystick. Remember to always look backwards before you start reversing to be sure that no person or thing is in the way.

Spin

Spin by moving the joystick gently sideways. Take care so nothing is in the way of the sides when you spin.

Turn

Turn as you drive by gently moving the joystick sideways in the same direction you want to turn. Always lower the speed when turning.

Obstacle

Practice avoiding and passing obstacles. Move the joystick sideways while driving forward to avoid obstacles. Remember to lower the speed as you approach obstacles.

Fast driving

Fast driving: Press the joystick in the forward position if you want to drive fast. Remember to retract the joystick and lower the speed as soon as you feel insecure, whether you are turning or approaching an obstacle

Run over obstacles

Drive slowly to the obstacle and make sure the front wheels are in the direction of travel. Then move the joystick slowly forward while leaning backwards to drive over the obstacles Eloflex is tested and approved for obstacles up to a maximum of 6 cm.

Sloping surfaces

Try driving straight up or down for an inclined surface. Lean slightly forward as you drive up, and backwards as you drive down, to maintain the center of gravity. Avoid driving sideways if possible and compensate for any side slope by leaning in the opposite direction. Always drive slowly on slopes and please note that stopping distance can be significantly greater than on level ground. Maximum allowed slope angle of this wheelchairs is 9 degrees. Even if your Eloflex are able to do so, avoid driving in slopes greater than the required test angle due to risk of serious injury in case of tipping.

Elevators

Remember to check the width of the elevator door and how quickly the door is closed before you enter the lift. Keep in mind that you may have to reverse out of the lift if it is not large enough to allow you to turn around.

Driving on the road

Drive primarily on sidewalks, walkways and cycle paths and, ultimately, on busy roadways with your Eloflex.

Cross the roadway

if possible, always choose to cross the road at a pedestrian crossing. Pay attention to intersecting cars. Use chamfered part of the pavement if available. Avoid curbs higher than 5 cm.

Tyres

If the wheelchair is equipped with air-filled tyres, regularly check the pressure at 2,5 bar. In case of puncture please refrain from further driving and contact your reseller or suitable repair shop for repair.

Safety instructions when driving

There is a risk of serious injury by tipping the wheelchair.

- Only drive in inclines that do not exceed the maximum specified angle
- Always use anti-tippers when traveling with Eloflex
- Driving downhill should always be done at a lower speed
- Avoid areas where there is a risk of icy or slippery surfaces
- Never try to drive up or down stairs with your power wheelchair
- Never drive over obstacles higher than the recommended maximum height
- Avoid rapid movements with the joystick and sudden changes in driving direction while driving

Risk of being stuck in remote places.

- A user with greatly reduced mobility should not drive longer distances outdoors alone

Risk of injury if one foot slips off the footrest and falls under the powered wheelchair while driving.

- Always place your feet in the middle of the footrest while driving

Risk of injury if you collide with other objects.

- Drive through narrow passages with the lowest speed and greatest attention
- Pay extra attention when approaching or driving close to tables due to pinching risk between the tabletop and the joystick and/or armrest.

There is a risk that the wheelchair will tip over if the anti-tip devices are removed, damaged or mounted at a position that deviates from the standard mounting.

- The anti-tip devices must always be mounted when the power wheelchair is used
- The anti-tip devices only work on a solid surface. On soft surfaces such as lawns and snow, the anti-tip device can lose its effect. Therefore, drive
- extremely carefully on soft surfaces.

Suspension

This wheelchair is equipped with spring suspension on all four wheels. This provides excellent ride comfort as well improved ability to smoothly navigate over obstacles, small curbs etc. The springs are pretensioned and does not need to be adjusted.



Safety

Crossing railway tracks

Always cross the railway track straight from the front, never obliquely from the side. Never cross the railway tracks alone, always have someone with you who can help you.

Sharp edges

Be careful when driving on steep slopes, as the chair is likely to break. Eloflex is tested and approved for gradient with a maximum of 9 degrees. Always have someone with you who can help you.

High edges

Be careful when driving up or out for an edge. Eloflex is tested and approved for edges up to a maximum of 6 cm. Always have someone with you who can help you.

Transfer

We recommend that you always have someone who can help you with transfers to and from your Eloflex. Always turn off the power before starting the movement. Always lift up the armrests and footrest before moving to make getting in and out of the chair easier.

Don't repair on your own

Never try to repair a broken power wheelchair on your own. If you try to repair the chair yourself, the warranty does not apply. Always turn to Eloflex or to the shop or assistant center that sold / prescribed the chair. Never modify your power wheelchair on your own.

No toy

Never allow children who do not normally use a power wheelchair to sit on or use your Eloflex.

Cleaning

Never clean your Eloflex with running water. Only wipe it with a damp cloth. If your Eloflex is slow to fold up and together, you can lubricate the joints with oil or silicone spray.

Beware of heat

Never leave your Eloflex in direct sunlight, near a heat source or open fire. The batteries may be damaged, and some surfaces may become so hot there is a risk of injury. You can use your Eloflex from -10 degrees up to +45 degrees. At low temperatures the driving range will be affected. The wheelchair is ignition resistant according to EN 12184.

Storage

Keep your Eloflex out of the reach of children when not in use. The chair should be stored indoors in frost-free, dry and ventilated areas. Storage temperature 0-30 degrees.

The charger

The charger must never be covered when used to charge your Eloflex. The charger becomes hot and there is a risk of accident or injury.

Batteries

Never store the batteries in direct sunlight or in a location that can reach below zero temperatures. The batteries should be stored in a dry and ventilated place. In case of disposal the batteries must be recycled according to national/local requirements. Please note that, like all battery-powered products, the driving range will decrease over time, including during the warranty period and the product's lifetime.

Usage

The Eloflex power wheelchair is designed to meet a variety of needs. The decision regarding its suitability for the user is made jointly by the coordinator or reseller and the user. Eloflex cannot accept responsibility if the power wheelchair is not appropriately adapted to the user's needs.

Modifications

Your Eloflex should primarily be used in its standard configuration. Any modifications or adjustments must only be performed by your authorised service centre or by Eloflex. Please be aware that damages or malfunctions caused by modifications not in accordance with the operating instructions or due to inadequate maintenance are not covered by the warranty.

General safety instructions

There is a risk of personal injury if the power wheelchair is used for purposes other than those described in this document.

- Use the power wheelchair only according to the instructions in this manual (see above, chapter "Type classification and intended use")
- Never use (be seated in) the wheelchair while its in transport in another vehicle car/bus.

There is a risk of personal injury if the power wheelchair is used for reduced driving ability.

- Do not use the wheelchair when your driving skills are impaired due to, for example, illness, medication or alcohol.

There is a risk of injury if the power wheelchair is involuntarily moved.

- Switch off the wheelchair before boarding and exiting or if there is a risk that you, another person or an object could come in contact with the joystick.
- When the motors are disengaged, the brakes do not work. Therefore, the wheelchair must only be pushed on flat ground, never on slopes. Never leave the wheelchair in or near slopes with disengaged motors.

There is a risk of personal injury if the powered wheelchair is switched off during travel with, for example, the on / off button or by tearing off a cable, as it stops with a hard jerk.

- Release the joystick when braking in an emergency. Then the wheelchair stops automatically.

There is a risk of injury due to falls from the wheelchair

- Do not move forward, do not bend forward between the knees and do not lean over the wheelchair edge, for example to reach objects.
- Its recommended to always use the seat belt and re-adjust it before each trip.
- When transferring between seats/vehicles, drive as close to the new position as possible to minimize the gap and risk of tipping the wheelchair.

There is a risk of personal injury if the maximum permissible load is exceeded.

- Observe the maximum permissible load (see chapter "Technical data" at the back of this document).
- The power wheelchair may only be used by a single person. Never use the wheelchair to transport more than one person at a time.

There is a risk of personal injury and damage to the wheelchair if the lock is released when folding is not properly clamped when the power wheelchair is used.

- If the power wheelchair's lock has not clicked into place properly, the chair can suddenly collapse when used, which can cause you to fall out of the wheelchair.
- Always ensure that the locking hook is in a correct position before using the power wheelchair.
- There is a risk of personal injury and crushing damage when folding the wheelchair.
- Always fold and raise the power wheelchair as described in the operating instructions.
- Pay attention so that none or nothing is squeezed when folding and unfolding.

There is a risk of personal injury and damage to the wheelchair if it is used in damp areas.

- The power wheelchair must not be used during howering.
- The power wheelchair must not be used when bathing.
- Avoid driving in rainy conditions for extended periods of time

EMC

- There is a risk that the wheelchair might disturb, or be disturbed by, equipment due to electromagnetic fields. This may affect the controls of the wheelchair.
- This device is equipped with Bluetooth transmitter. For more information please contact your reseller.

Technical specifications **R**

Net Weight	29 kg without batteries
Total weight	32,5 kg including batteries
Speed	6,5 km/h
Range	30 km*
Duration	5 hours per charge
Motor	2 x brushless high power motor
Motor effect	2 x 250 Watt
Battery	2 x Litium ION 10 AH / 24 V (240 Wh) (+1 extra slot)
Battery weight	1,8 kg
Charging time	3 hours
Turning radius	88 cm
Max. inclination	9 degrees static, 6 degrees dynamic
Wheels	front 8" (solid), rear 12" (air) (2,5 bar)
Seat height	55 cm
Seat width	43 cm
Seat depth	43-48 cm
Max user weight	160 kg
Joystick	Right or left mounted
Cushion	Detachable, removable cover
Backrest	8°- 30°
Size	102,5 cm (height) x 62 cm (width) x 108,5 cm (depth)
Size folded	44 cm (height) x 62 cm (width) x 89 (87**) cm (depth)
Warranty	2 Years
Max. obstacle	5 cm

* Distance during optimal conditions, and will effected by temperature, driving style, elevation and battery condition etc.

** Calf support removed

© Copyright Eloflex

This document contains copyrighted information and may not be copied or reproduced in whole or in part without the written permission of Eloflex. Eloflex accepts no responsibility for any typographical errors in this document and reserves the right to make product changes.

Contact Eloflex

If you have any questions, require assistance, or need information about product recalls or safety notices, please contact your help centre or local dealership. If necessary, you can find the product's serial number on a sticker located on the underside of the chassis.



2021-05-08

Version 2.0

Sungo Europe B.V.

Olympisch Stadion 24, 1076DE

Amsterdam, Netherlands

SRN:NL-AR-000000247



Eloflex

Hammarbacken 4B

191 49 Sollentuna

SWEDEN

+46 10-18 33 100

info@eloflex.eu

www.eloflex.eu

Kunshan Aoshida Electric Technology Co., Ltd

No. 108 Matang Road, Penglang Town, Development Zone, Kunshan City, Jiangsu